

Is AI

(Artificial Intelligence)

BS?

(Building Science)



UNIVERSITY OF
WATERLOO

Department of Civil and
Environmental Engineering
Architectural Engineering

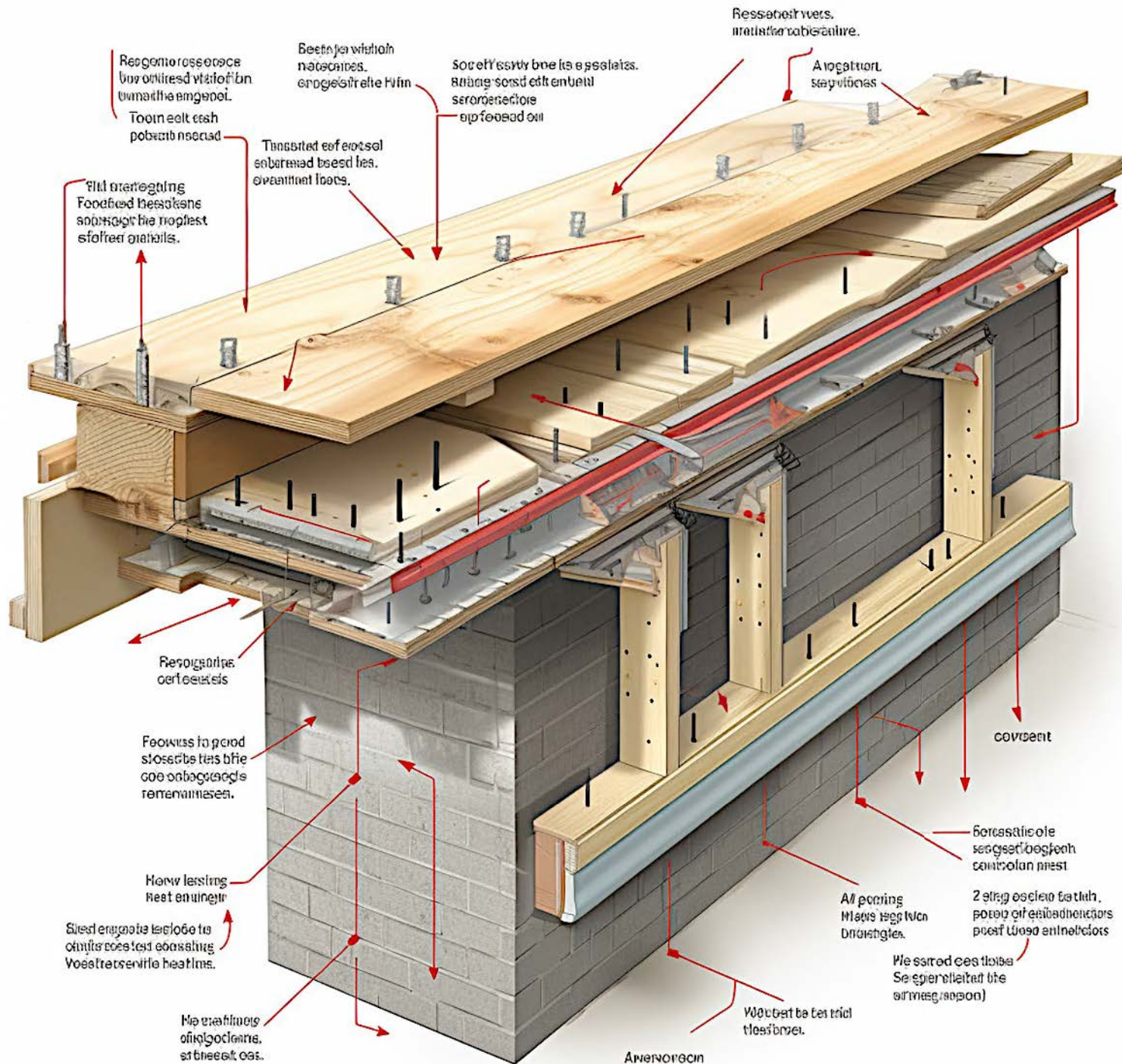

Over to Dr Bob....



Robert Bowerman, Ph.D., P.Eng.
Principal, RLMS.AI

What are Generative AIs and Large Language Models ???



- Generative AI
 - Models that create new content – e.g., audio, images, text, or videos
- Large Language Model
 - Large AI model with billions of parameters
 - Trained on trillions of words on input
 - Works by “next word prediction” based on user input and previously generated text
 - Very clever version of predictive text algorithm (like on your smart phone keyboard)
- On its own, an LLM can produce text but has **no domain expertise**

How can you add domain expertise ???

- Retrieval-Augmented Generation (RAG) is a technique to provide domain expertise to a large language model
- For a given question, it searches a semantic database and finds relevant content
- The LLM answers the question with the relevant content given as context

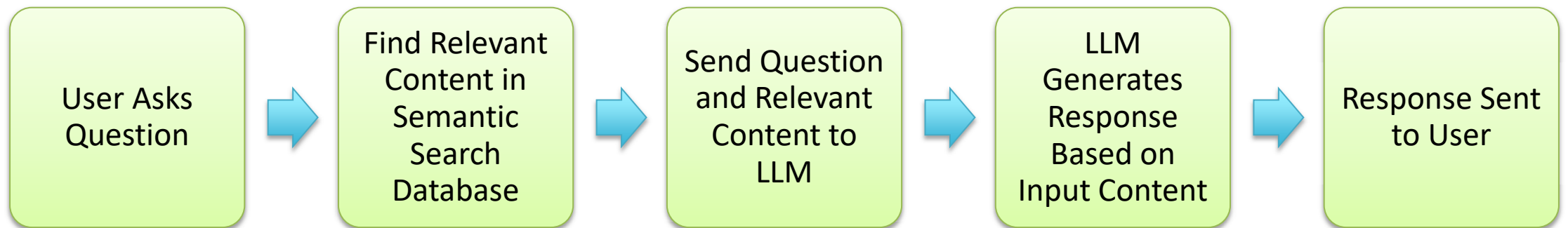

Why BuildingScience.com ???

- Extensive and curated repository
 - Large set of high-quality, objective building science information
 - Clear and consistent point of view
- Opportunity to extend reach
 - Help mandate of promoting the design and construction of buildings that are healthier, less energy-consuming, and more durable and economical





LIVE DEMO

<https://bscassistant.ai>