

The Quirkiness of Details

George "Captain Quirk" Fritz
Foster Lyons
Horizon Builders

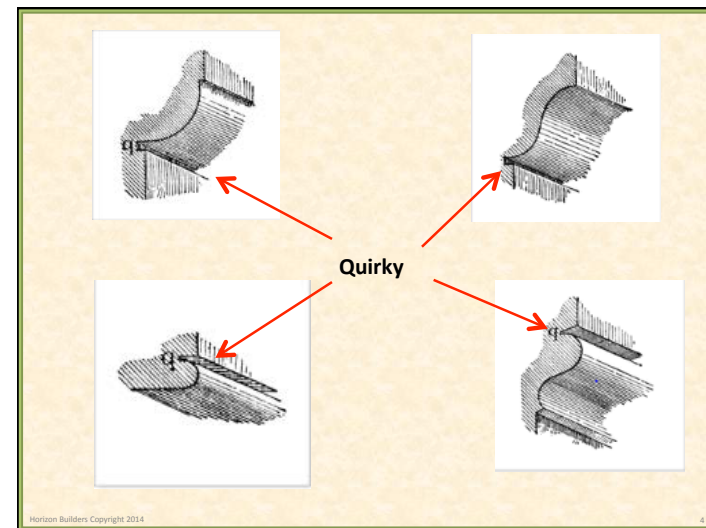

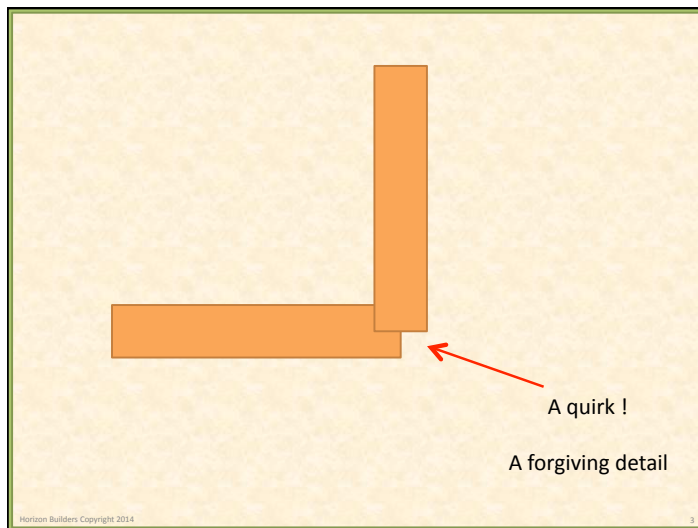
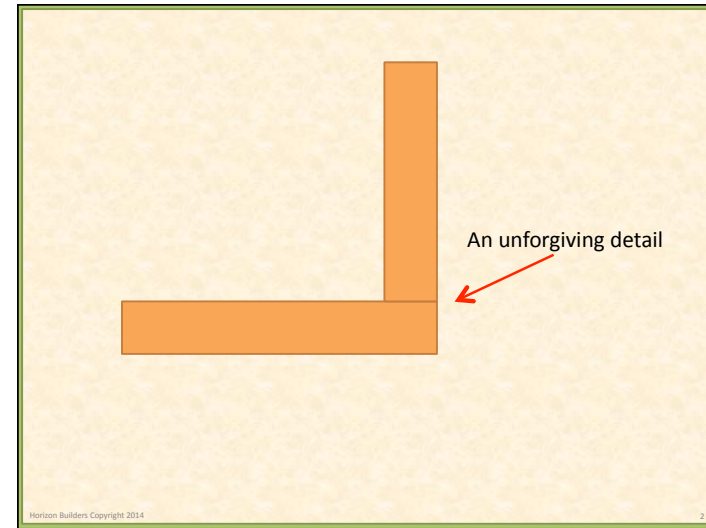

Brick Ties, Stone ties Problems and Process Solutions

Horizon Builders Copyright 2014

Problems

- Stone ties fastened with unapproved fasteners.
- Stone ties miss the 'mark'
- Ties that fail to 'tie'
- 'WRB's', drainage issues and redundancy

Horizon Builders Copyright 2014





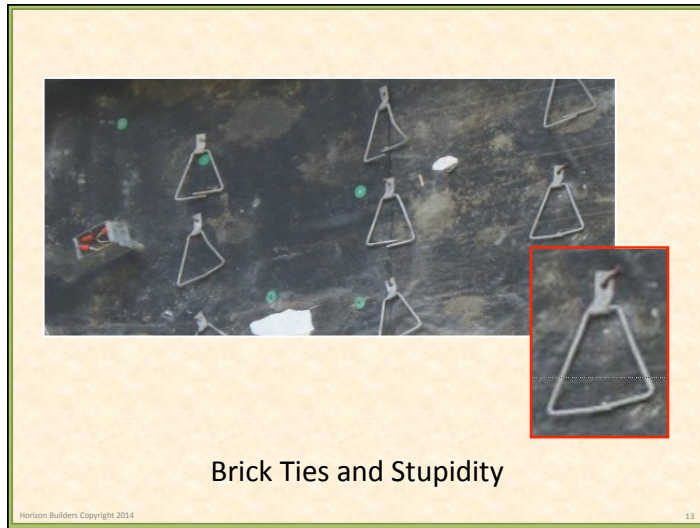

Solutions

- The plywood becomes the 'stud'
- One stop shopping: a tie that ties – no choices here
- Liquid applied 'WPABL'
- Insulation that:
 - Drains and allows to drain
 - Dries
 - Allows to dry
 - Insulates
 - Protects

Horizon Builders Copyright 2014 14

It's Hard to Find a Stud When You Need One

WALL SHEATHING AND FASTENER SCHEDULE	
ITEM	DESCRIPTION
10	1/2" Plywood on exterior side
11	1/2" Plywood on exterior side
12	1/2" Plywood on exterior side
13	1/2" Plywood on exterior side
14	1/2" Plywood on exterior side
15	1/2" Plywood on exterior side
16	1/2" Plywood on exterior side
17	1/2" Plywood on exterior side
18	1/2" Plywood on exterior side
19	1/2" Plywood on exterior side
20	1/2" Plywood on exterior side
21	1/2" Plywood on exterior side
22	1/2" Plywood on exterior side
23	1/2" Plywood on exterior side
24	1/2" Plywood on exterior side
25	1/2" Plywood on exterior side
26	1/2" Plywood on exterior side
27	1/2" Plywood on exterior side
28	1/2" Plywood on exterior side
29	1/2" Plywood on exterior side
30	1/2" Plywood on exterior side
31	1/2" Plywood on exterior side
32	1/2" Plywood on exterior side
33	1/2" Plywood on exterior side
34	1/2" Plywood on exterior side
35	1/2" Plywood on exterior side
36	1/2" Plywood on exterior side
37	1/2" Plywood on exterior side
38	1/2" Plywood on exterior side
39	1/2" Plywood on exterior side
40	1/2" Plywood on exterior side
41	1/2" Plywood on exterior side
42	1/2" Plywood on exterior side
43	1/2" Plywood on exterior side
44	1/2" Plywood on exterior side
45	1/2" Plywood on exterior side
46	1/2" Plywood on exterior side
47	1/2" Plywood on exterior side
48	1/2" Plywood on exterior side
49	1/2" Plywood on exterior side
50	1/2" Plywood on exterior side
51	1/2" Plywood on exterior side
52	1/2" Plywood on exterior side
53	1/2" Plywood on exterior side
54	1/2" Plywood on exterior side
55	1/2" Plywood on exterior side
56	1/2" Plywood on exterior side
57	1/2" Plywood on exterior side
58	1/2" Plywood on exterior side
59	1/2" Plywood on exterior side
60	1/2" Plywood on exterior side
61	1/2" Plywood on exterior side
62	1/2" Plywood on exterior side
63	1/2" Plywood on exterior side
64	1/2" Plywood on exterior side
65	1/2" Plywood on exterior side
66	1/2" Plywood on exterior side
67	1/2" Plywood on exterior side
68	1/2" Plywood on exterior side
69	1/2" Plywood on exterior side
70	1/2" Plywood on exterior side
71	1/2" Plywood on exterior side
72	1/2" Plywood on exterior side
73	1/2" Plywood on exterior side
74	1/2" Plywood on exterior side
75	1/2" Plywood on exterior side
76	1/2" Plywood on exterior side
77	1/2" Plywood on exterior side
78	1/2" Plywood on exterior side
79	1/2" Plywood on exterior side
80	1/2" Plywood on exterior side
81	1/2" Plywood on exterior side
82	1/2" Plywood on exterior side
83	1/2" Plywood on exterior side
84	1/2" Plywood on exterior side
85	1/2" Plywood on exterior side
86	1/2" Plywood on exterior side
87	1/2" Plywood on exterior side
88	1/2" Plywood on exterior side
89	1/2" Plywood on exterior side
90	1/2" Plywood on exterior side
91	1/2" Plywood on exterior side
92	1/2" Plywood on exterior side
93	1/2" Plywood on exterior side
94	1/2" Plywood on exterior side
95	1/2" Plywood on exterior side
96	1/2" Plywood on exterior side
97	1/2" Plywood on exterior side
98	1/2" Plywood on exterior side
99	1/2" Plywood on exterior side
100	1/2" Plywood on exterior side

Horizon Builders Copyright 2014 15

Solutions and Process...Heckmann Pos-I-Tie

Horizon Builders Copyright 2014 16

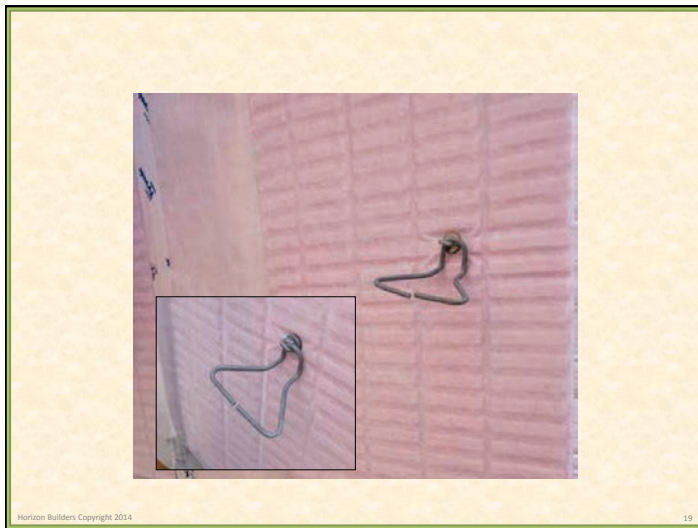

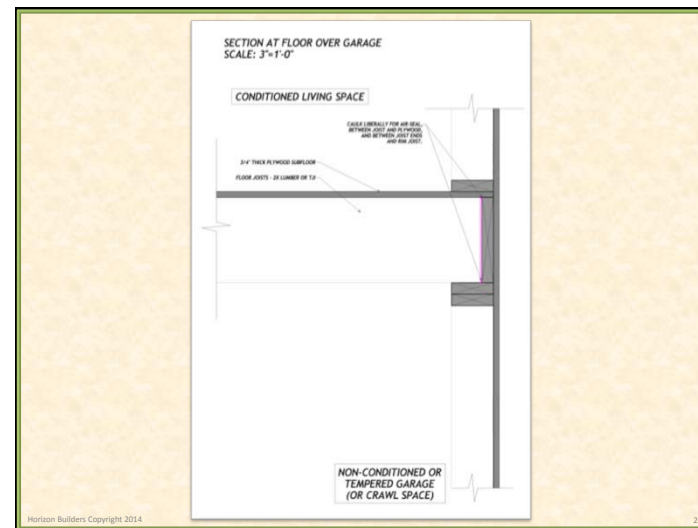
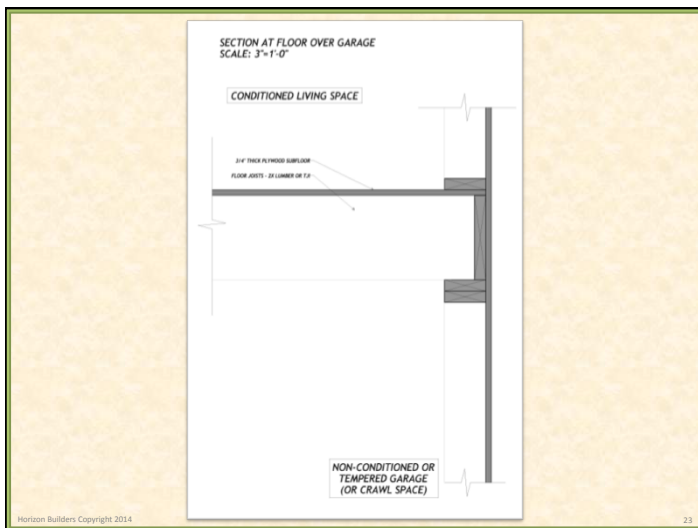
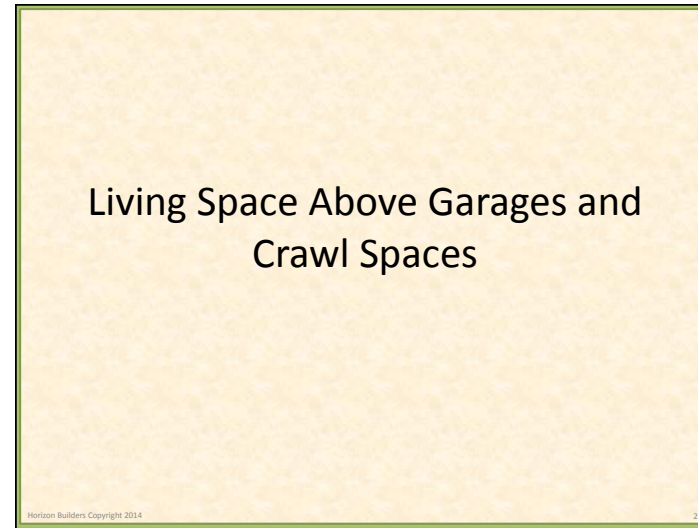
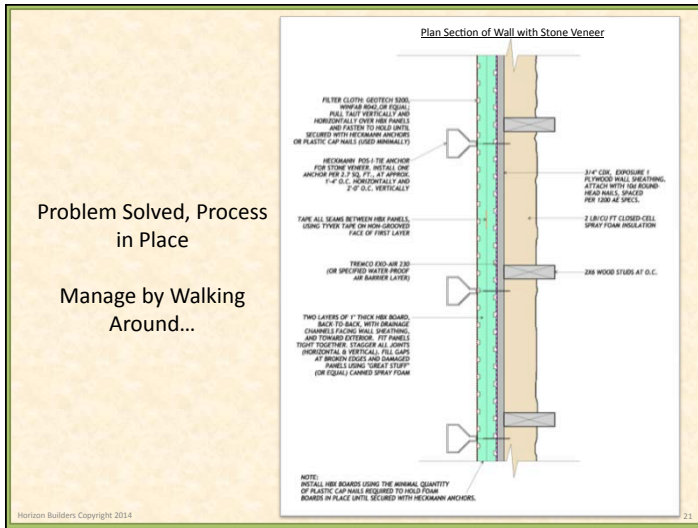

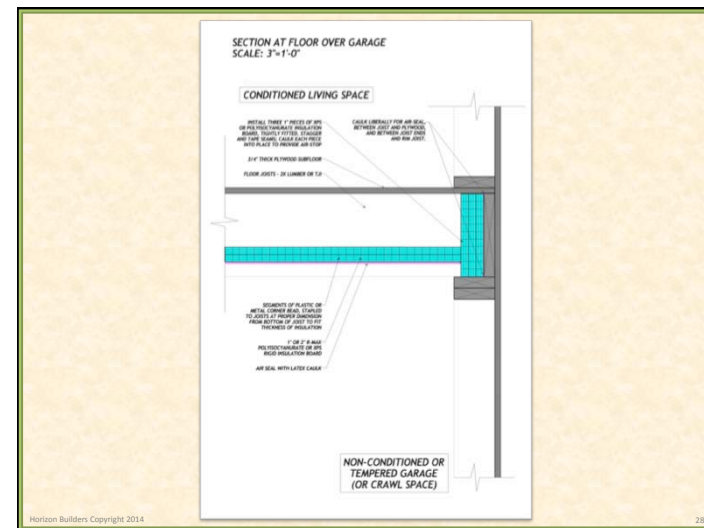
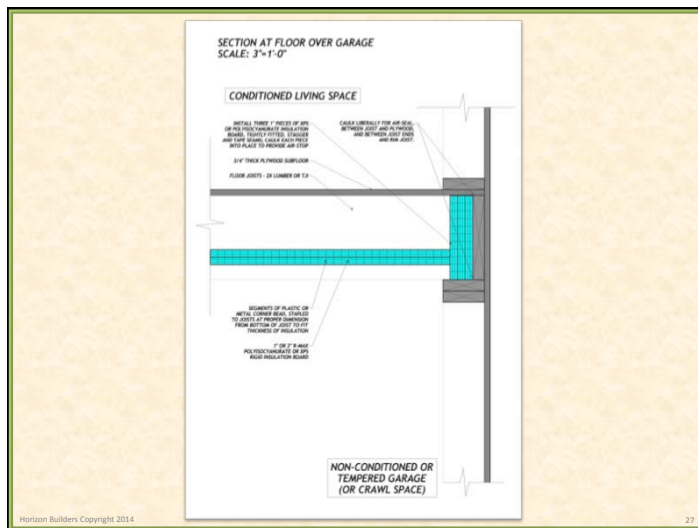
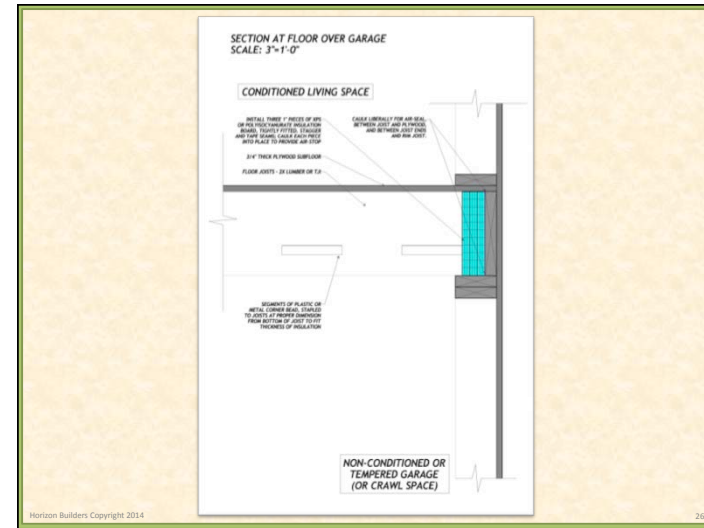
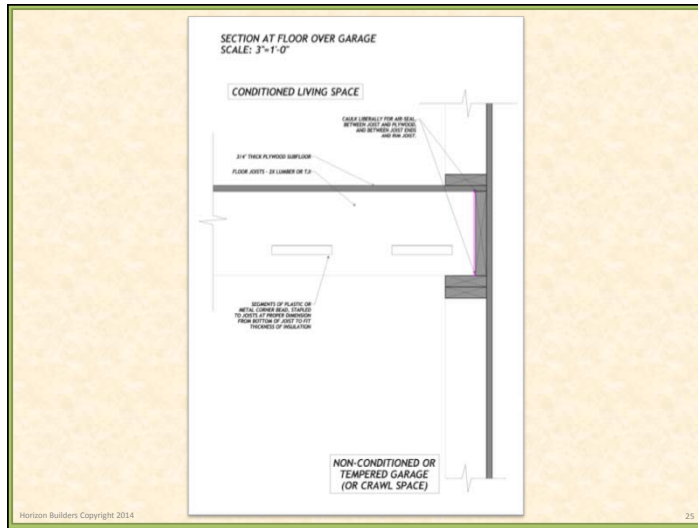

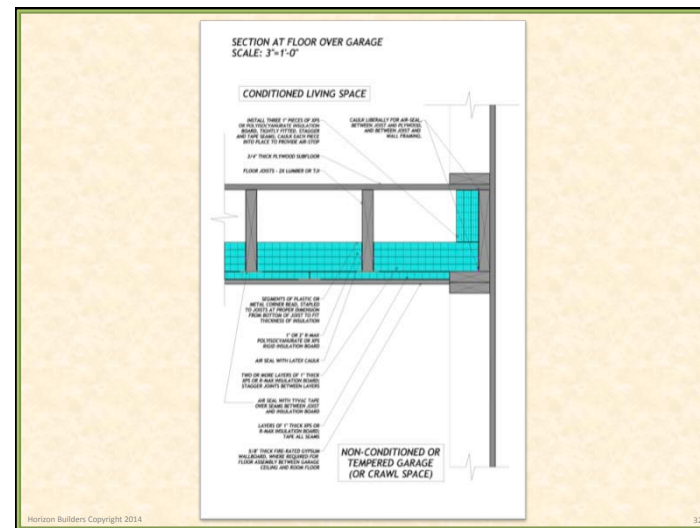
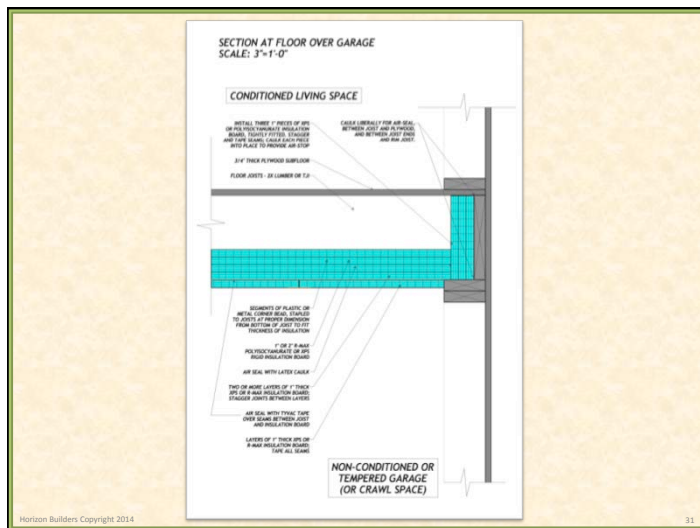
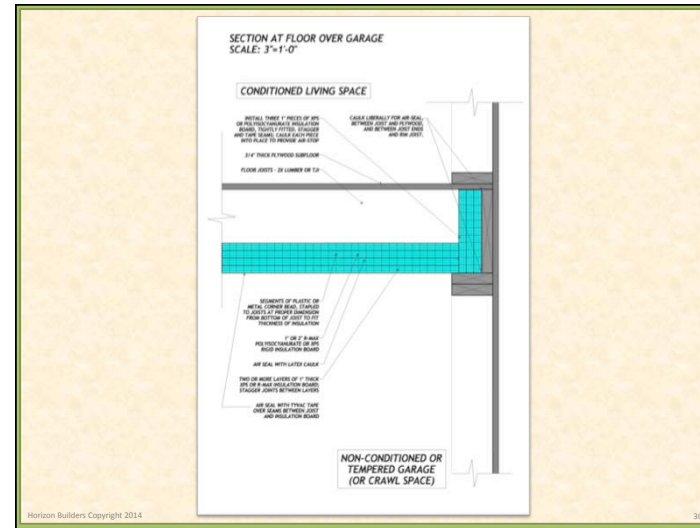
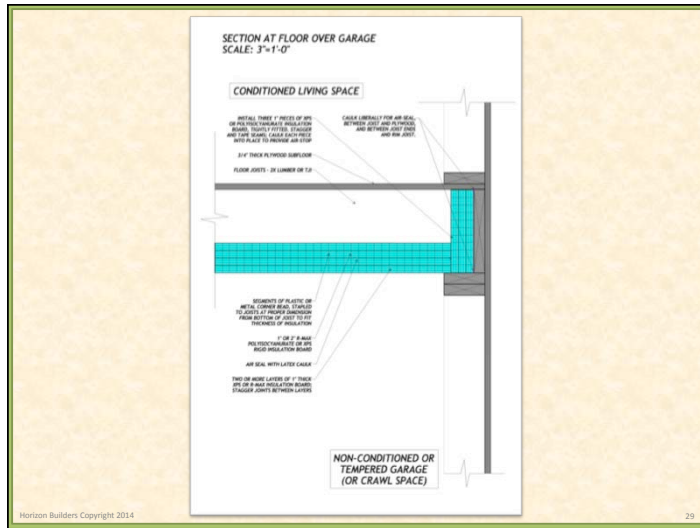

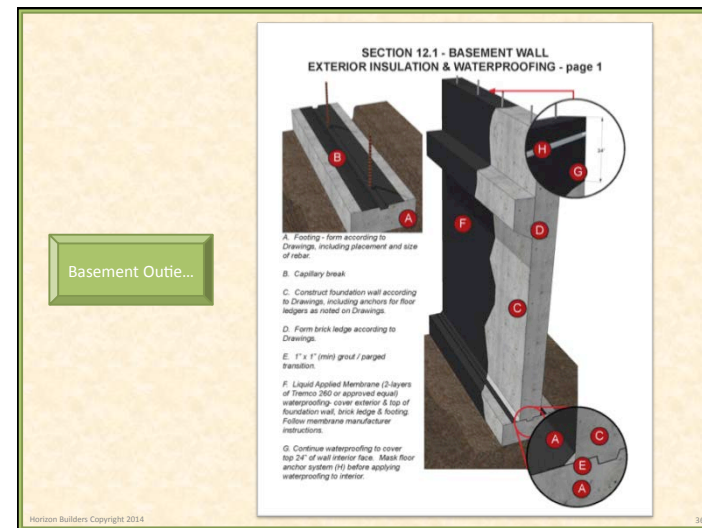
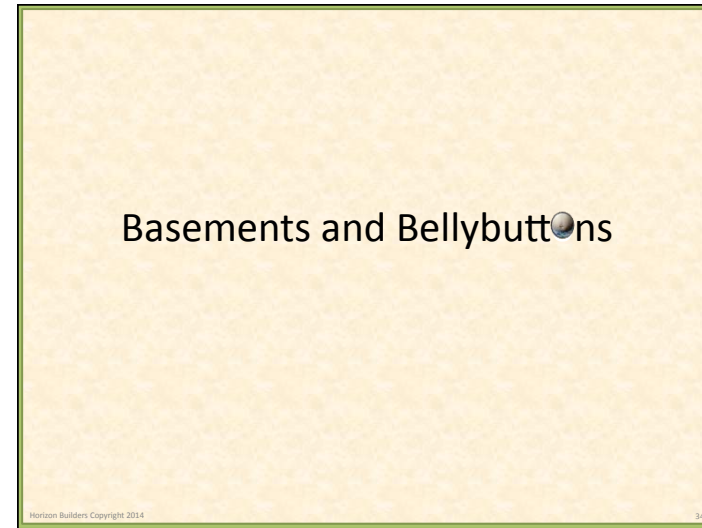
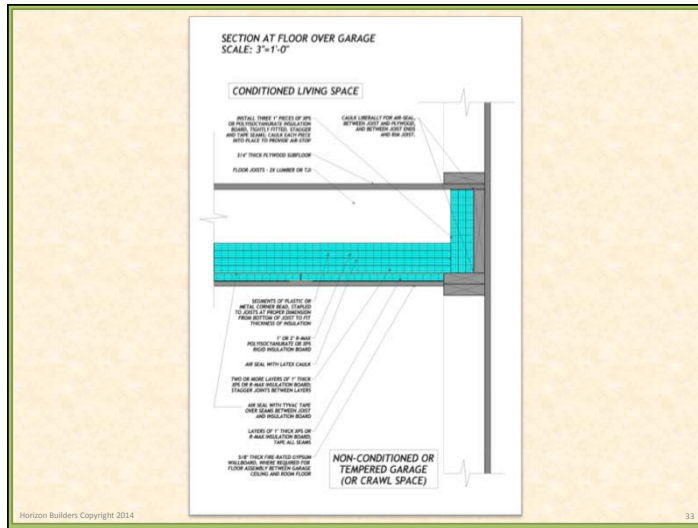

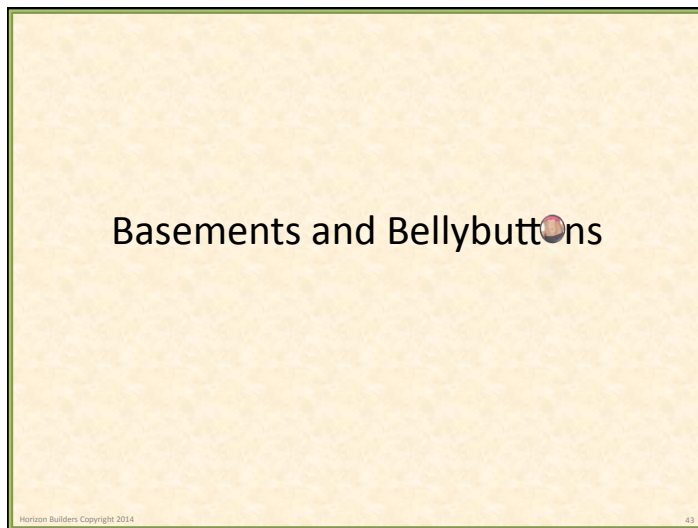
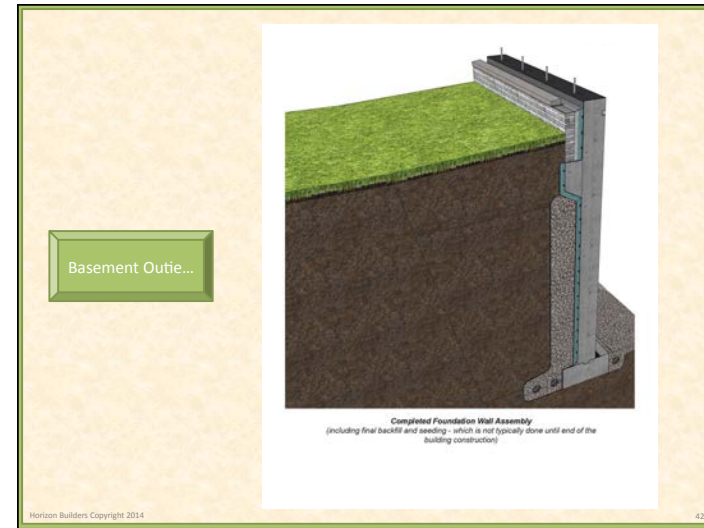
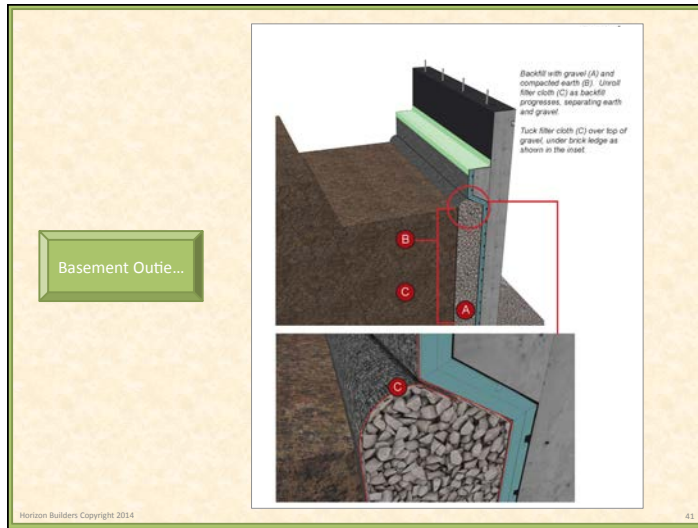

Basement Innie...

SECTION 05.2 - FLOOR & WALL FRAMING - LEDGER OFFSET

A. Completed foundation wall with waterproofing, peel-n-stick cap flashing, drainage plane, etc.
 B. Haffen FK-4 Floor cast-in-place anchoring system per Structural Drawings & Specification.
 C. Haffen FK-4 Offset Support Bracket (per Structural Drawings & Specifications). Adjust bracket height to align top of beam with top of wall sill plate (installed later).
 D. Glulam (Anthony Powerbeam or eqva) per Structural Drawings and Specifications.
 E. Lag bolts to anchor beam to bracket per Structural Drawings & Specifications - pre-drill holes in bracket support angle.

Horizon Builders Copyright 2014 45

Basement Innie...

Horizon Builders Copyright 2014 46

Basement Innie...

Horizon Builders Copyright 2014 47

Basement Innie...

SECTION 12.2 - BASEMENT WALL INTERIOR WATER DRAINAGE

A. 4" gravel sub-slab drainage layer (or per Drawings) - top of gravel should be level w/top of wall footing.
 B. Drainage sheet (Delta 6200 or similar) from bottom of wall to bottom of floor framing above. Drainage channels shall face the wall (see 2D detail). Overlap horizontal seams 2" to 4" minimum, with lower sheet in FRONT of upper sheet. Overlap vertical seams 2" to 4".
 C. Fasten to wall using Delta Fast'ner or similar approved for use with drainage sheet product.
 D. Seal all seams (vertical and horizontal) using approved tape or mastic. Do not seal bottom sheet to the footing (allow water to drain over footing).

Horizon Builders Copyright 2014 48

Basement Innie...

A. Bend and install additional layer of Delta 6200 (or similar) drainage sheet along base of wall, with drainage channel facing the wall (B) and top of footing (C) (see 2D detail). Extend horizontally over entire width of footing and 1-2" into grave (E). Extend up vertical face of wall to 6" above slab when installed (approx. 12" up wall).

C. Terminate (seal) base sheet to face of wall drainage plane (D) using approved tape or mastic. Seal all joints between base sheets using tape or mastic. This is a GAS seal.

Horizon Builders Copyright 2014 49

Basement Innie...

2D detail of completed interior base drainage assembly.

Note that Delta 6200 (or similar) drainage sheet is installed with channels facing the wall. Water is intended to drain between the wall and drainage sheet, over the top of the footing and into the gravel layer. All drainage sheet layers shall be sealed using approved tape or mastic.

Vapor barrier between slab and insulation layer turns up wall and is similarly terminated (sealed) to the face of the drainage plane.

Horizon Builders Copyright 2014 50

Basement Innie...

A. (2) layers of 1" XPS rigid foam insulation (or per Drawings & Specifications) - stagger joints.

B. 15 mil Stego vapor barrier sheet (or equivalent per Drawings & Specifications), turn up wall 12" min. Tape edge to drainage sheet temporarily as necessary to pour slab (E).

C. Bond break

D. 4-5" concrete slab (or per Drawings)

E. Terminate (seal) edge of Stego to drainage sheet (F) using approved tape or mastic (GAS seal).

Horizon Builders Copyright 2014 51

Basement Innie...

SECTION 05.3 - BASEMENT WALL FRAMING, INSULATION & FINISH

Interior Basement Wall Framing

A. Completed foundation wall with gas-sealed interior drainage plane.

B. Sill gasket between metal base plate & concrete

C. 2x4 light gauge metal framing, HPSI 2-1/2" distance between framing & drainage plane.

D. Anchor base plate to concrete slab using approved coated masonry bolts.

E. Attach studs to base plate using sheet metal screws.

F. Attach metal framing to floor framing above using approved blocking and fasteners.

Horizon Builders Copyright 2014 52

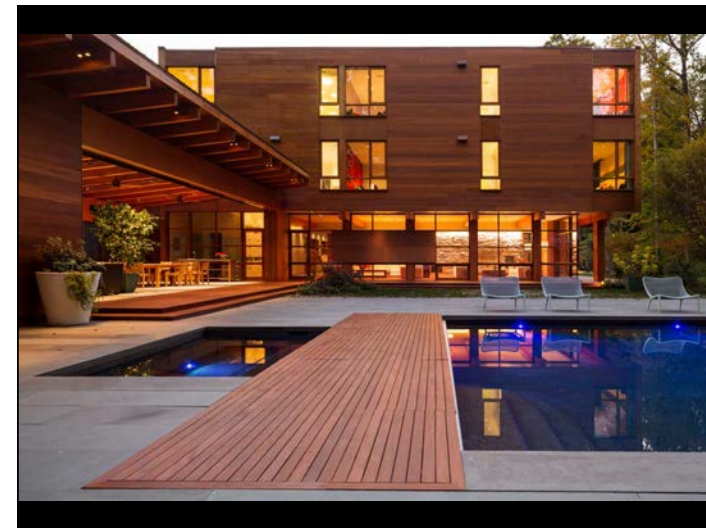
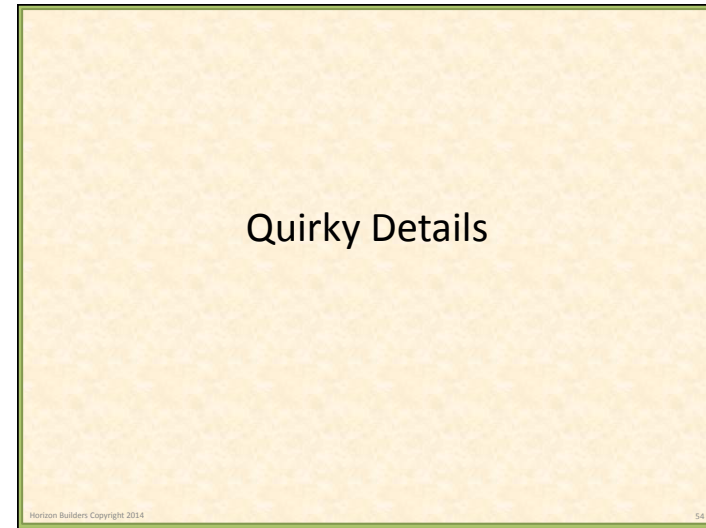
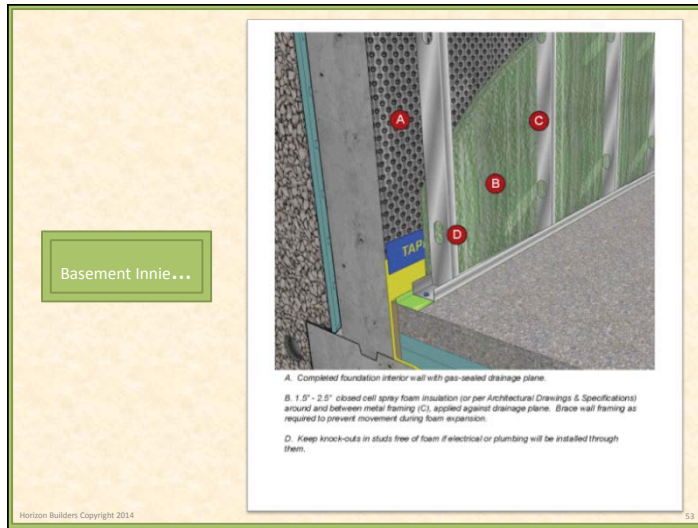

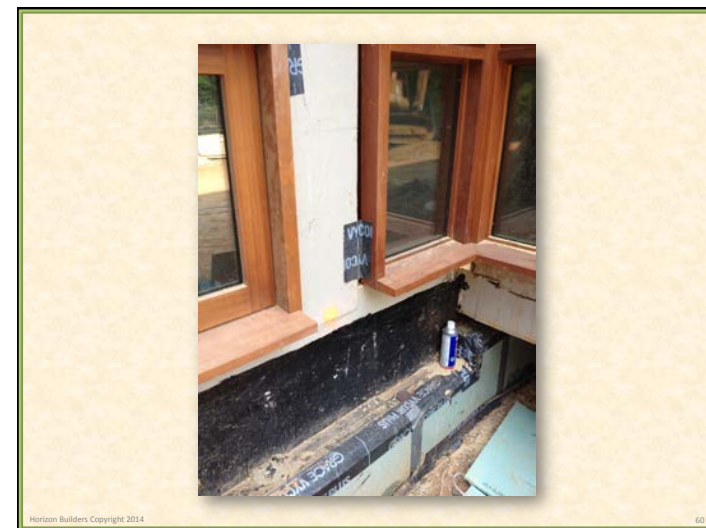
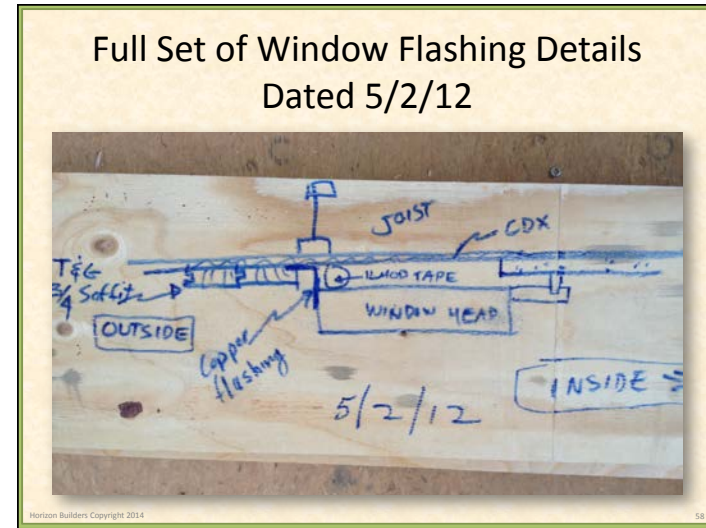

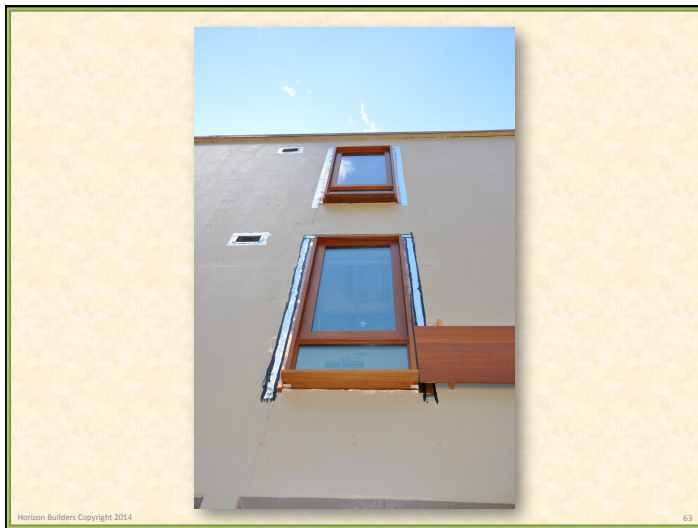

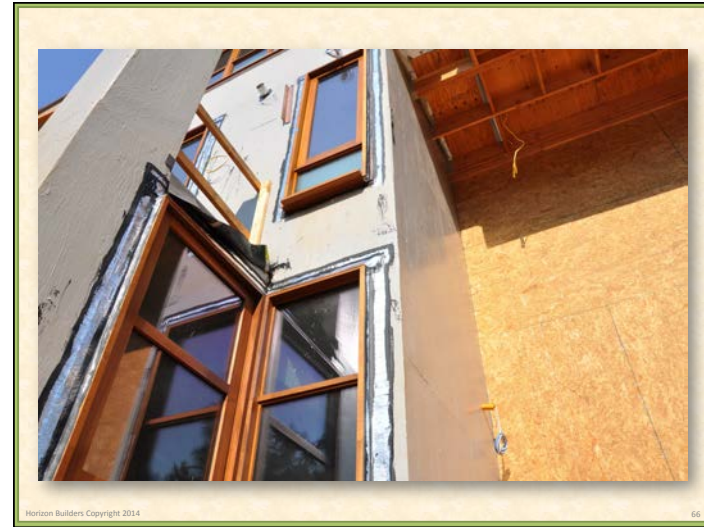

Horizon Builders Copyright 2014

66



Horizon Builders Copyright 2014

67



Horizon Builders Copyright 2014

68



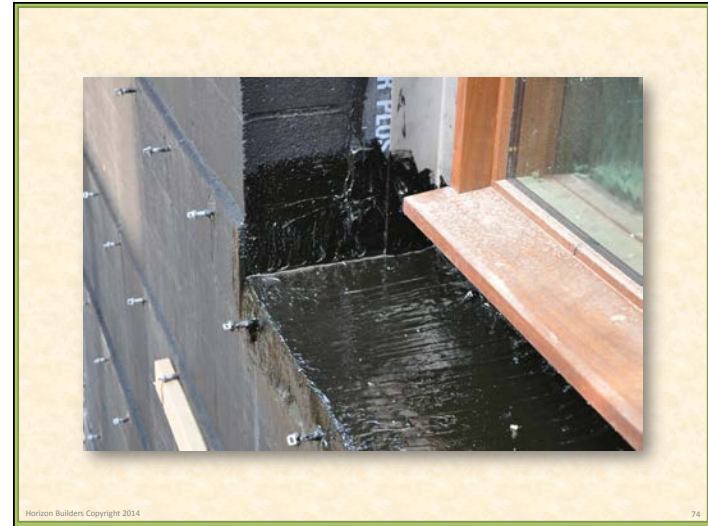

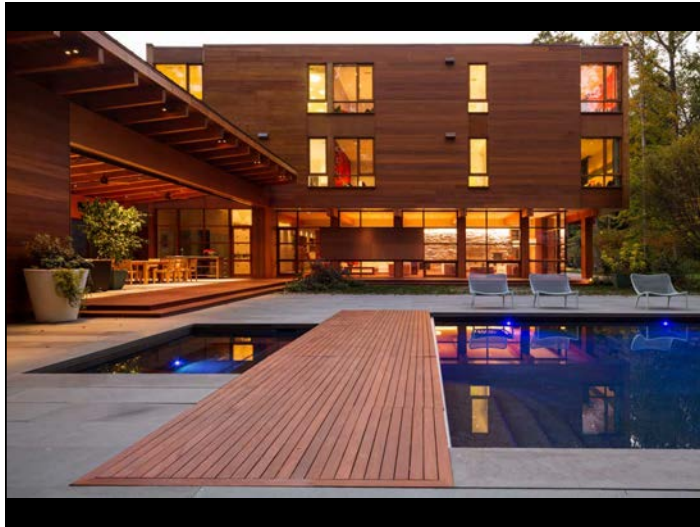

Horizon Builders Copyright 2014

75



Horizon Builders Copyright 2014

76

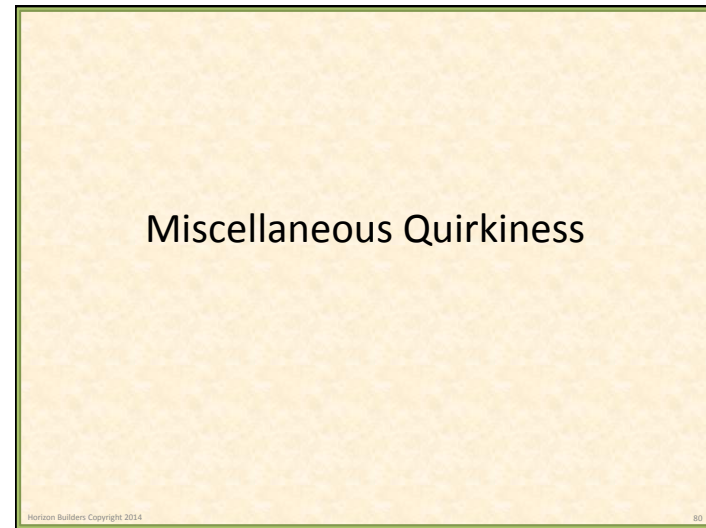

Horizon Builders Copyright 2014

80



Horizon Builders Copyright 2014

83



Horizon Builders Copyright 2014

83

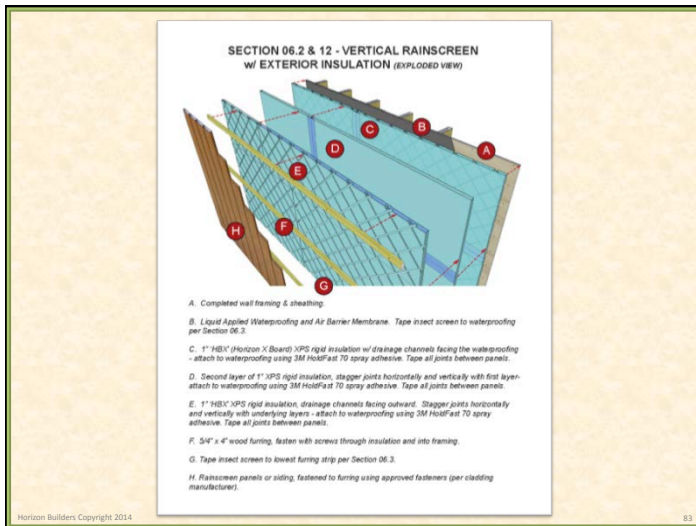

Horizon Builders Copyright 2014

83

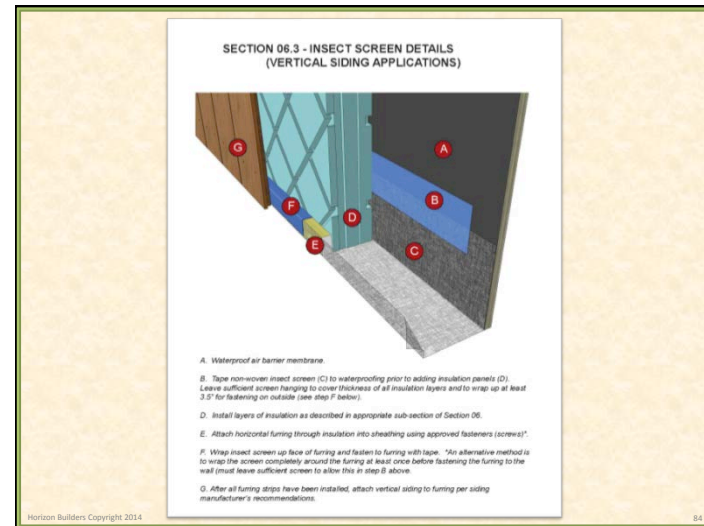

Horizon Builders Copyright 2014

84

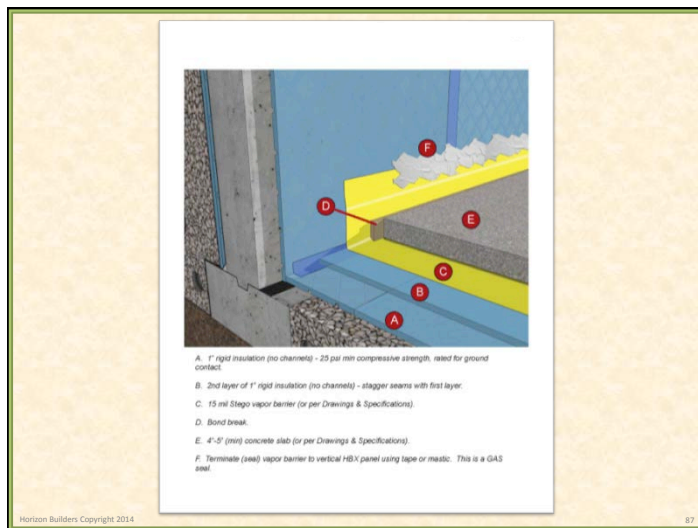
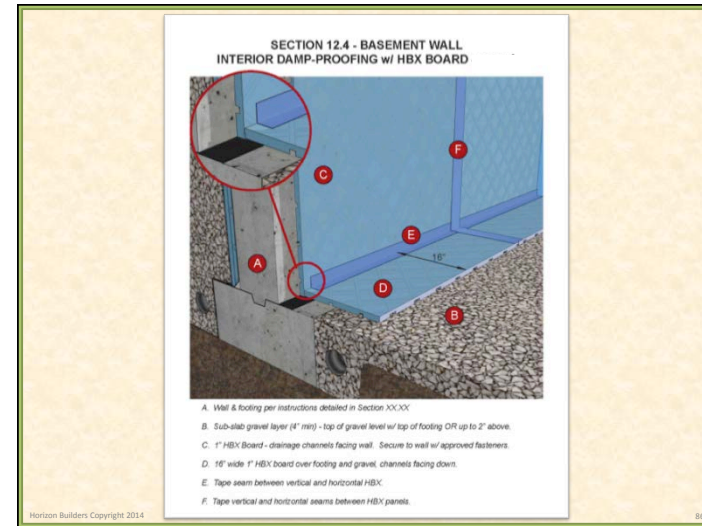
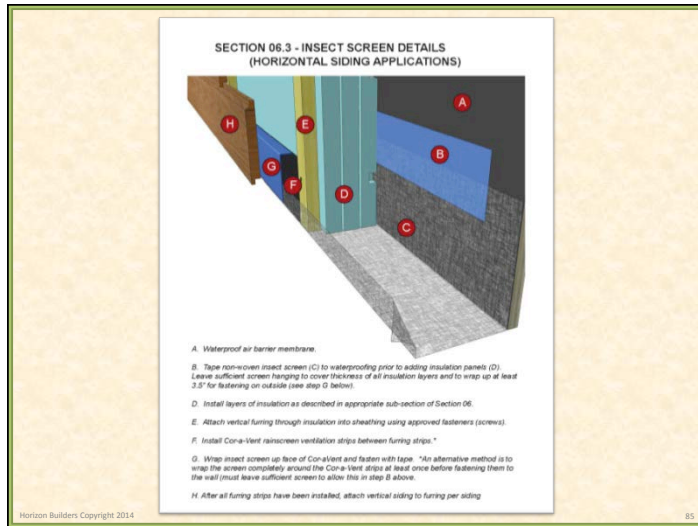

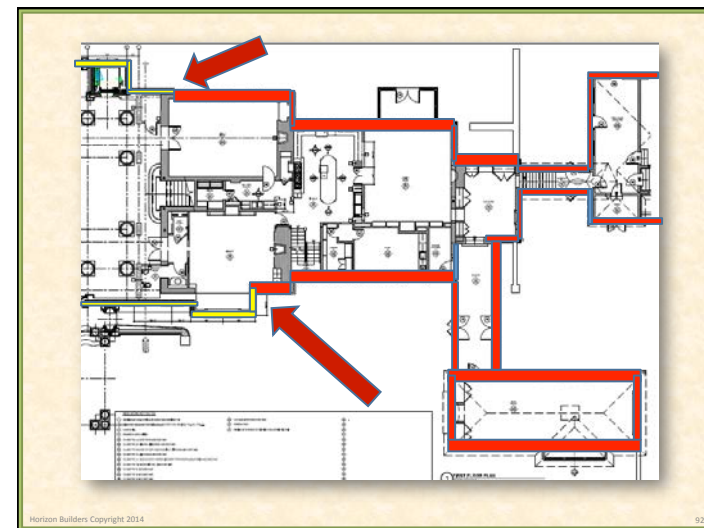
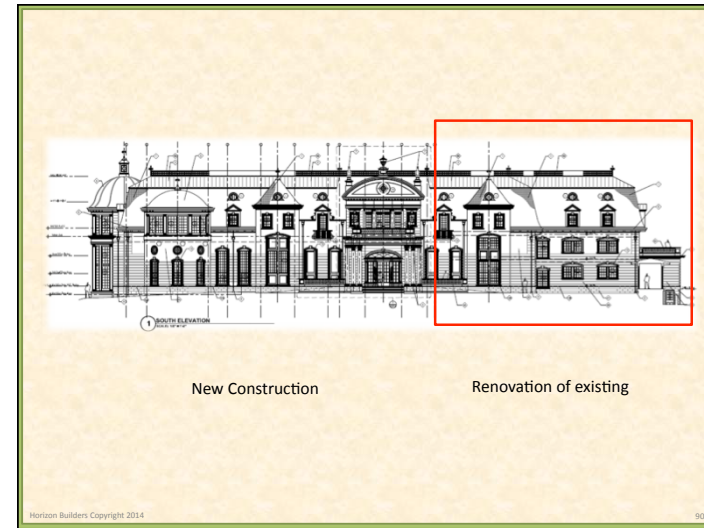
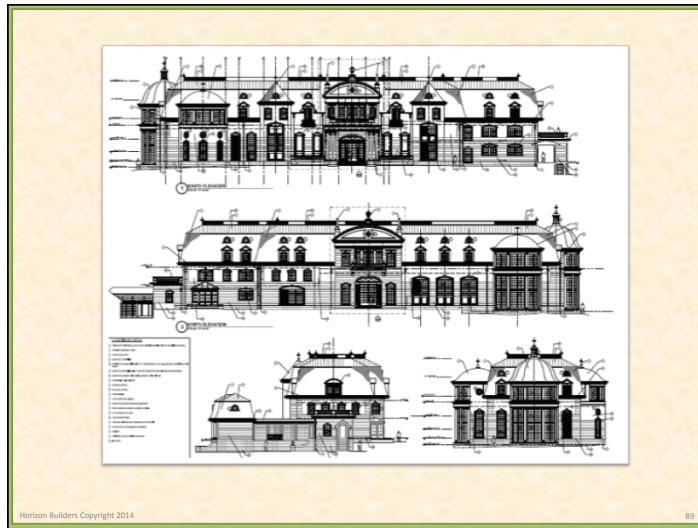

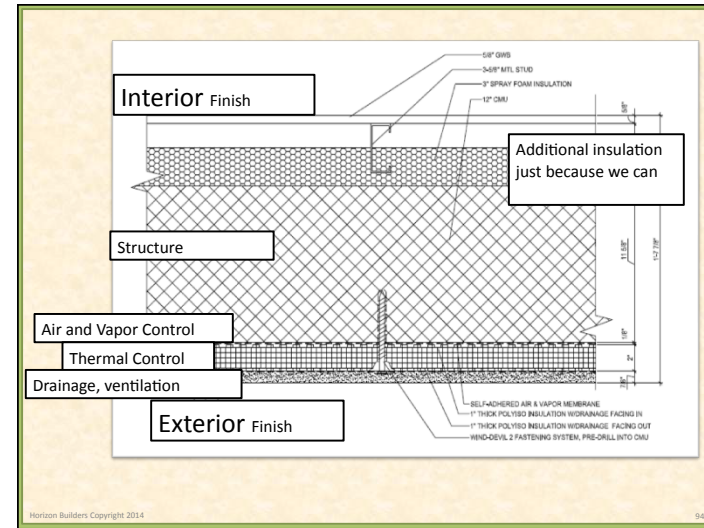
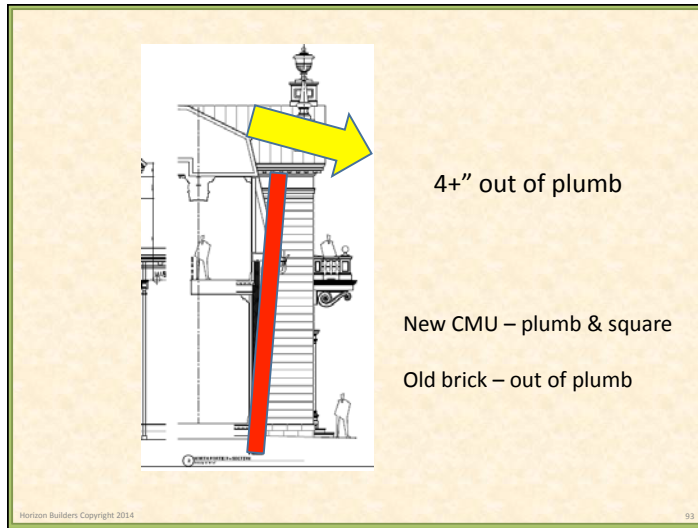



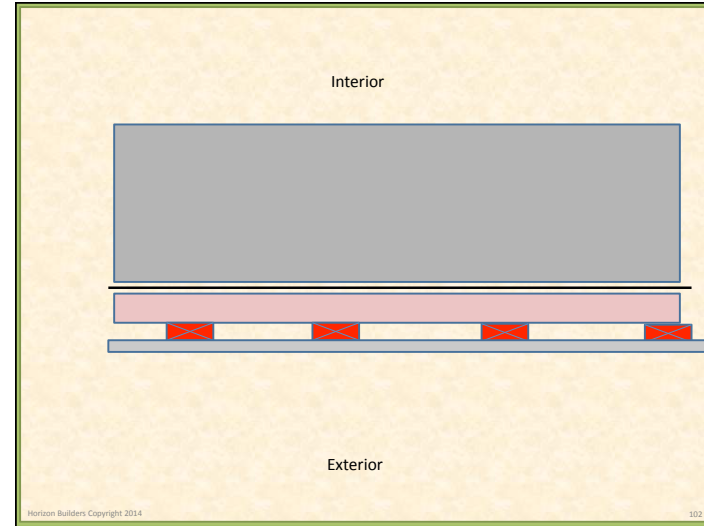

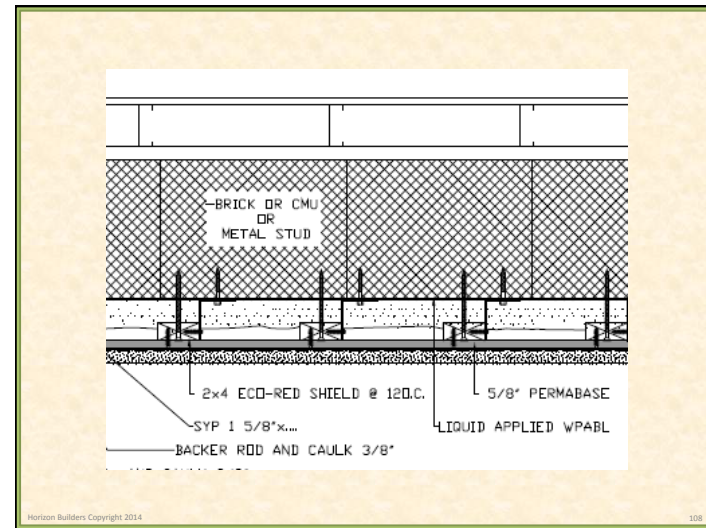
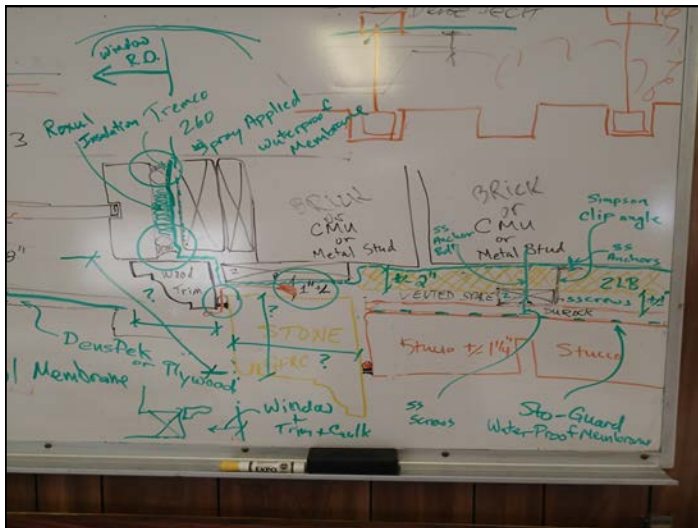

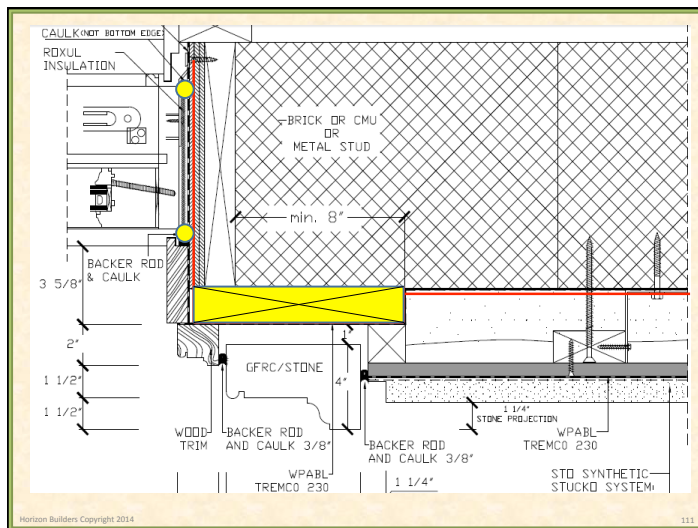
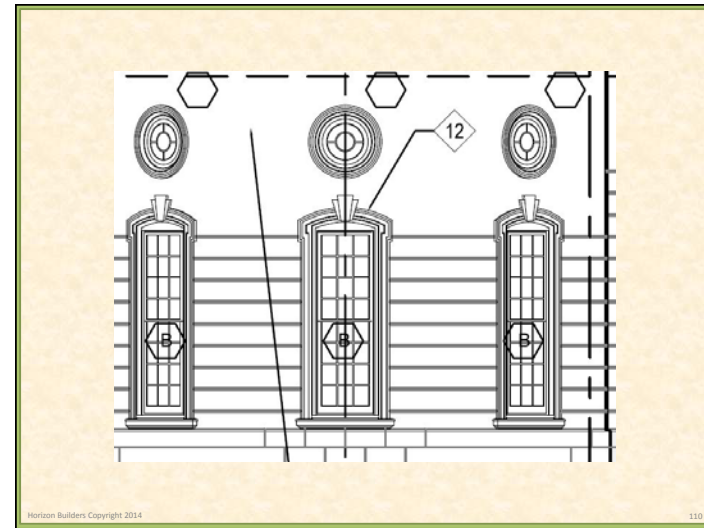

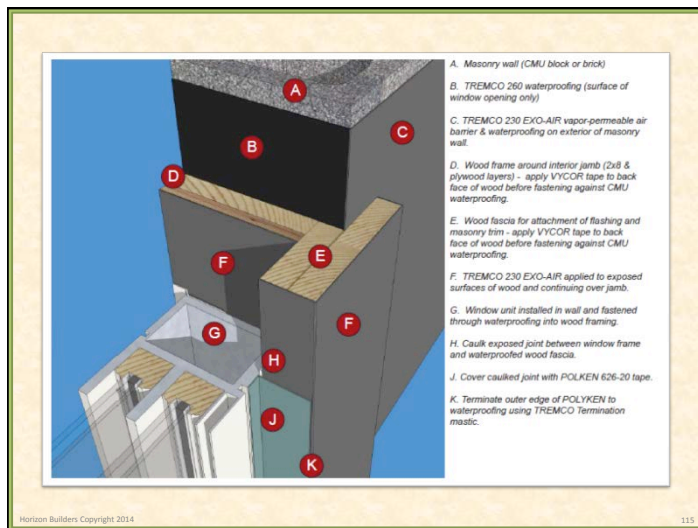
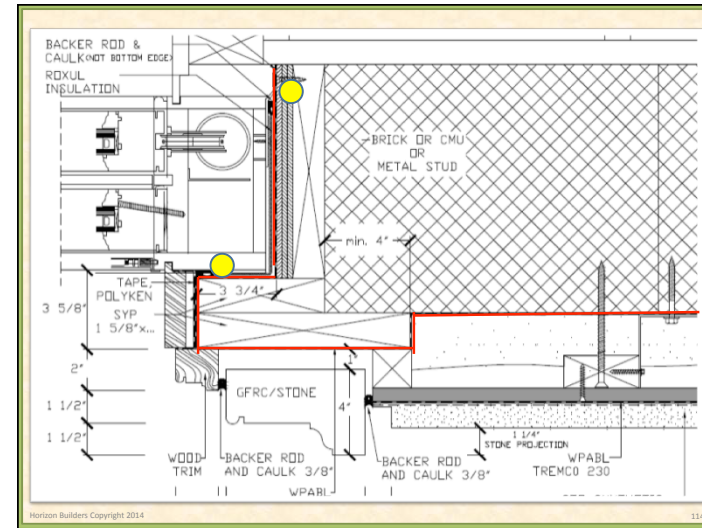
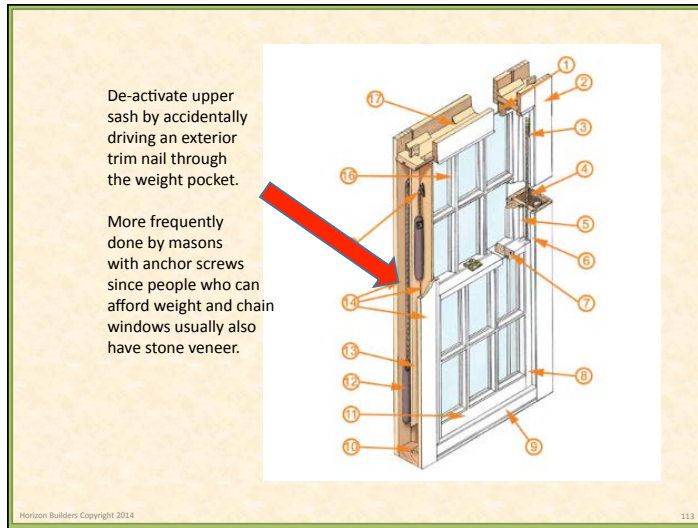





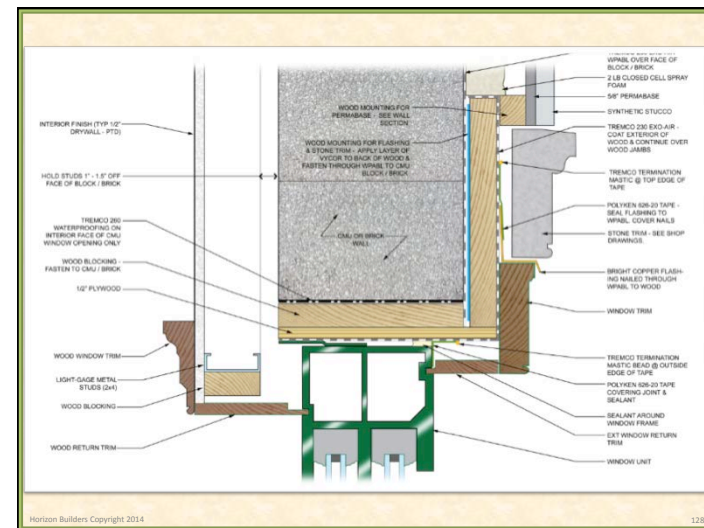
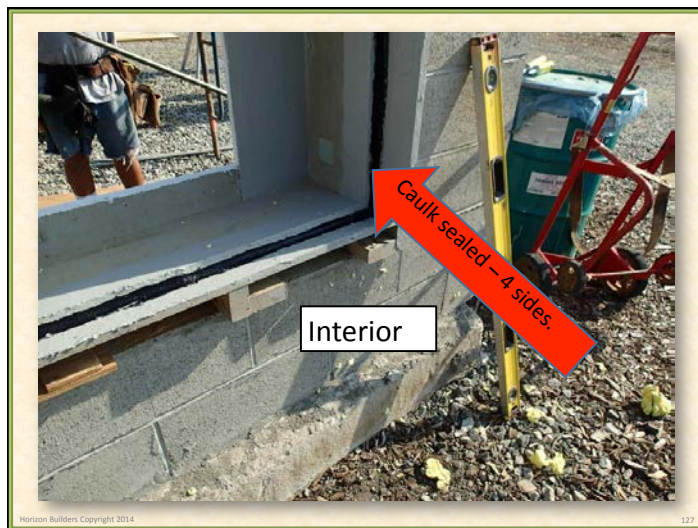
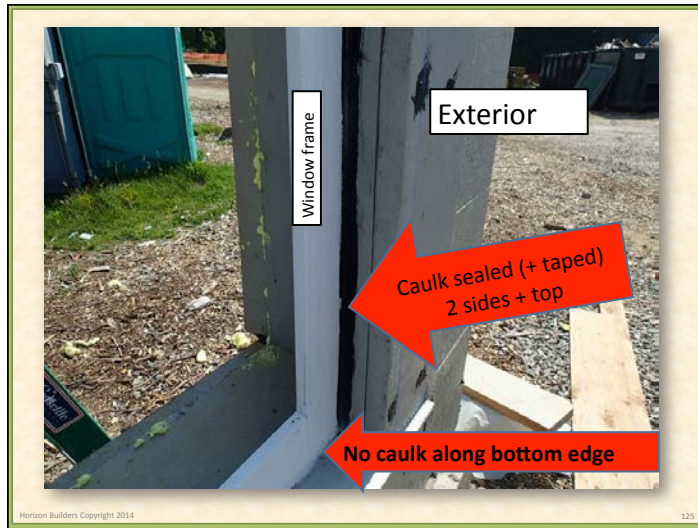

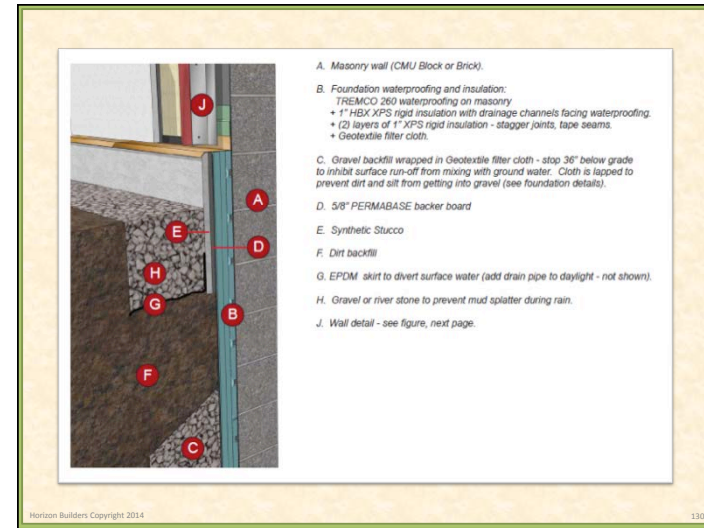
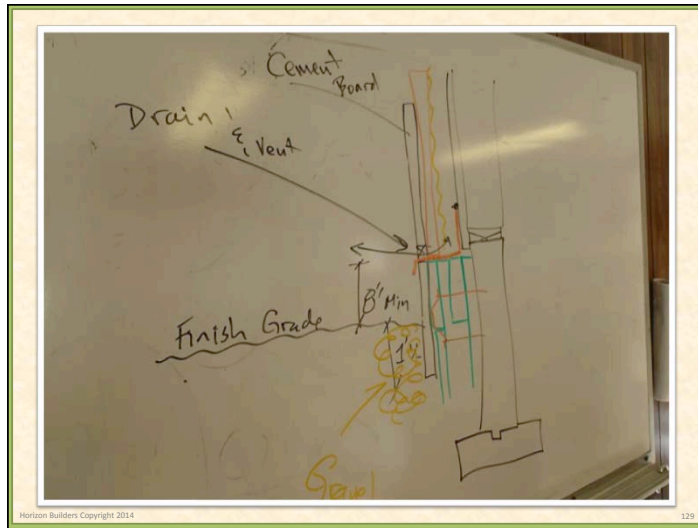



Thank you for your time!

Questions?

George Fritz, COO
Horizon Builders
george@horizonbuildersinc.net

Horizon Builders Copyright 2014 137



H O R I Z O N
B U I L D E R S

— SINCE 1982 —

Extreme Craftmanship. Exceptional Service.

Horizon Builders Copyright 2014 138